

The image shows a lush tropical garden with a wooden walkway leading to a pond with lily pads. A person is walking on the path. In the background, there are traditional Thai wooden houses with tiled roofs. The Anantara logo, a stylized triangle with three smaller triangles inside, is positioned above the text 'ANANTARA MAI KHAO PHUKET VILLAS'.

ANANTARA  
MAI KHAO PHUKET  
VILLAS

# Anantara Mai Khao Phuket Villas

Anantara Mai Khao Phuket Villas is a serene retreat on Phuket's north-western tip, inspired by traditional southern Thai wooden houses and set amidst Bill Bensley-designed lagoons. The resort spans two wings: the North Wing, resembling a Thai village with dining at Tree House, Sea Fire Salt and Tiffin by La Sala, along with the newly opened Bua Bar for premium white spirits and cocktails and the South Wing, a secluded haven with spacious suites, Aqua Pool Bar, Talad for Western favourites and Claws & Co. for fresh seafood. The Active Zone features a gym, outdoor fitness, rock climbing and a teen zone, while the South Wing offers a Kids' Club and Fitness Club.

Anantara Spa provides indulgent treatments that blend ancient traditions with modern luxury, offering a deeply rejuvenating experience. Meanwhile, Designer Dining by Anantara presents private dining in the resort's most luxurious and picturesque settings, where bespoke menus, impeccable service and breathtaking views create an unforgettable culinary journey for special occasions.



# Location

The resort is just 15 minutes from Phuket International Airport, nestled along the island's peaceful northwest coast between Sirinath National Park and the golden sands of Mai Khao, Phuket's longest beach. This tranquil spot is not only a natural haven but also an important area for marine conservation.

**Opening date:** 2008

**Management:** Anantara Hotels & Resorts

**Ownership:** Minor International PCL

**General Manager:**

Serge Cuypers

[scuypers@anantara.com](mailto:scuypers@anantara.com)

# Accommodation

## Luxurious Suites & Private Pool Villas

Discover refined luxury at Anantara Mai Khao Phuket Villas, where spacious suites and private pool villas offer an exclusive retreat in a serene tropical setting. Designed for comfort and elegance, each accommodation features expansive living spaces, private pools and bespoke amenities. With Anantara's signature hospitality, every stay is an invitation to indulge in sophistication and tranquility.



Room type		Room size (m2)	Outdoor Space size (m2)	Max occupancy
Deluxe Mai Khao Suite (20 Units)				
20 Kings		81	13	2A + 2C
Two Bedroom Mai Khao Suite (37 Units)				
37 Kings	37 Twins	115	13	4A + 2C
Two Bedroom Pool Suite (8 Units)				
8 Kings	8 Twins	115	94	4A + 2C
Three Bedroom Pool Suite (2 Units)				
4 Kings	2 Twins	166	180	6A + 3C

Room type		Room size (m2)	Outdoor Space size (m2)	Max occupancy
Pool Pavilion (14 Pavilions)				
14 Kings		120	75	3A + 1C
Two Bedroom Pool Pavilion (16 Pavilions)				
16 Kings	16 Twins	158	107	4A + 2C
Three Bedroom Connecting Double Pool Pavilion (1 Pavilion)				
2 Kings	1 Twin	278	182	6A + 3C
Four Bedroom Connecting Double Pool Pavilion (1 Pavilion)				
2 Kings	2 Twins	316	214	9A + 3C
Pool Villa (43 Villas)				
33 Kings	10 Twins	63	123	2A + 1C
Lagoon Pool Villa (21 Villas)				
19 Kings	2 Twins	63	123	2A + 1C
Lotus Villa (1 Villa)				
1 King		63	123	2A + 1C
Sala Pool Villa (9 Villas)				
9 Kings		63	143	2A + 1C
Two Bedroom Family Pool Villa (8 Villas)				
8 Kings	8 Twins	87	112	4A + 1C
Two Bedroom Connecting Double Pool Villa (7 Villas)				
7 Kings	7 Twins	126	246	4A + 1C
Two Bedroom Royal Villa by Jim Thompson (1 Villa)				
1 King	1 Twin	172	217	4A + 1C
<b>Total rooms</b>		<b>183</b>		

# Accommodation

## DELUXE MAI KHAO SUITE

Spend languorous days on a sun-soaked, secluded balcony overlooking the lush expanse of the resort hub, tempting you to take a dip or enjoy a swim-up cocktail. Order in or prepare a quick meal in your kitchenette, then unwind in the cosy living room with high-tech entertainment, before drifting off to sleep, enveloped by cosy linens in your sumptuous bedroom.



## TWO BEDROOM MAI KHAO SUITE

Treat your loved ones to a stylish seaside retreat with all the comforts of home. The little ones will love staying amid the vibrant, contemporary designs with expansive play areas, plenty of space for movie nights and pillow fights. Prepare a delicious meal with market-fresh ingredients in the kitchenette or order perfectly blistered pizza for a family night in.



## TWO BEDROOM POOL SUITE

Issuing an invitation to linger, our two-bedroom pool suite promises sun-kissed days of outdoor sunbathing and indoor lounging. Slide open the glass doors, and there is your private pool, perfectly enveloped by tropical flora and calling your name.



## THREE BEDROOM POOL SUITE

Revel in true seclusion and a slower pace of life after days of island-hopping in our largest suite, designed for ultimate privacy and relaxation. Bask in the sun, savour homemade meals and enjoy each other's company on your private poolside patio. Inside, three ensuite bedrooms open onto a spacious living room, perfect for cooking, dining and unwinding together.





### **POOL PAVILION**

At 195 sqm, pool pavilions provide space to luxuriate. Lounge on your sundeck, dive into your oversized pool, then retreat into the cool shade of your garden sala or indoor living room.



### **TWO BEDROOM POOL PAVILION**

Ideal for families, these pavilions boast two ensuite bedrooms that open onto a central living room. Slide open glass doors onto the oversized pool and splash away the day. Meals can be prepared in the kitchenette and enjoyed together out on the sundeck.



### **THREE BEDROOM CONNECTING DOUBLE POOL PAVILION**

With two pavilions interconnected and spread over 460 sqm of tranquil gardens, these accommodations are ideal for larger parties who also require privacy. Enjoy a quiet coffee overlooking your personal pool, then come together for convivial meals served up by your Villa Host.



### **FOUR BEDROOM CONNECTING DOUBLE POOL PAVILION**

Our most extravagant pavilions are 0 sqm in size and accommodate parties of up to 16. Splash in one of two pools under the sun. Unwind in both indoor and outdoor living spaces, then retire to sanctuary ensuite bedrooms equipped with the latest in technology and comforts.



### **POOL VILLA**

Located around our boutique resort, each Pool Villa is elegantly inspired by southern Thai style. Alfresco pleasures abound, from a personal pool with a built-in deep terrazzo bathtub to a hardwood sundeck with loungers and umbrellas and a sala with a comfortable daybed, all enclosed within a private garden.



### **LAGOON POOL VILLA**

Offering a coveted setting beside the expansive tropical lagoon, Lagoon Pool Villas features a sumptuous bedroom and an en-suite bathroom with indoor and outdoor rain showers. Facing the lagoon, a personal pool with a built-in terrazzo tub, a sundeck with loungers and a living Sala.



### **LOTUS VILLA**

The Lotus retreat, paradise awaits Immerse yourself in the cinematic allure of the Lotus Villa, one of the best villas in Phuket and a haven of romance nestled in a tropical island paradise. This spacious one-bedroom retreat features a private pool, outdoor bathtub, serene lagoon views and an outdoor relaxation area, perfect for intimate, secluded dining or unwinding in tranquil bliss.



### **SALA POOL VILLA**

Nestled around the lagoon, Anantara's exclusive Sala Pool Villas offer a romantic sanctuary. In addition to a personal pool and sundeck, these villas boast the unique allure of a wooden walkway extending across the lagoon to an overwater Sala, with curtains that can be drawn for blissful privacy or opened for a stunning lagoon view.



### **TWO BEDROOM FAMILY POOL VILLA**

Each Two Bedroom Family Pool Villa offers luxurious seclusion and the ultimate island lifestyle to share as a family or with good friends. Elegant lounge and dining spaces, opening onto a garden courtyard where relaxing days can be spent enjoying the private pool, sun loungers and living sala, as well as the outdoor bathtub and with views of the lush lagoon.



### **TWO BEDROOM CONNECTING DOUBLE POOL VILLA**

The Two Bedroom Connecting Double Pool Villas are ideal for families or friends traveling together. These villas are perfect for staying close without having to compromise on privacy. With two of everything – including pools – there is ample room for everyone to enjoy Anantara’s luxuries in the comfort of their own space. Each master bedroom has its own king-sized bed and en-suite bathroom with the option to indulge in a bath or shower under the stars.



### **TWO BEDROOM ROYAL VILLA BY JIM THOMPSON**

This luxurious two-bedroom pool villa is inspired by Jim Thompson fabrics and offers uncompromised luxury and a coveted location, just a few steps from the exquisite white sands of Mai Khao Beach. Covering an expansive 389 sqm of private space, giving guests a capacious and idyllic haven to relax in. Enjoy breathtaking sunsets from your personal ‘floating’ sala, take a dip in the 67 sqm private pool, or unwind in the sunshine on the generously proportioned timber deck.



# Villa features

Discover refined comfort at Anantara Mai Khao Phuket, where private suites in the South Wing provide serene views and exclusive amenities, while the North Wing offers a choice of tranquil tropical retreats or designer villas set amidst Bill Bensley’s lush gardens or over the peaceful lagoon, all with effortless access to dining and leisure.

## Villa

- King or twin bed
- Private sqm swimming pool
- Outdoor sundeck with loungers and sun umbrellas
- Outdoor living sala
- Work desk with power sockets
- Wi-Fi internet access
- Telephone with voicemail
- LED TV, Bluetooth sound system
- In-room safety deposit box
- Individually controlled air conditioning with ceiling fans

## Pavilion

- King or twin bed
- Private sqm swimming pool
- Outdoor sundeck with loungers and sun umbrellas
- Outdoor living sala
- Work desk with power sockets
- WiFi internet access
- Telephone with voicemail
- LED TV, Bluetooth sound system
- In-room safety deposit box
- Individually controlled air conditioning with ceiling fans
- Beverages
- Tea and coffee making facilities (Nespresso machine)

- Resident’s wine cellar
- Beverages
- Tea and coffee making facilities (Nespresso machine)
- Large balcony or terrace
- LED TV in living areas and all bedrooms
- Bluetooth music system
- Coffee machine
- Hair dryer
- In-room safety deposit box
- Complimentary Wi-Fi throughout resort

- Ensuite bathrooms feature double basins, a rain shower and oversized bathtub
- Large balcony or terrace
- Big living and dining spaces
- Fully equipped kitchen, with a large refrigerator, stove top
- Washing machine and dryer
- LED TV in living areas and all bedrooms
- Bluetooth music system
- Coffee machine
- Hair dryer
- In-room safety deposit box
- Complimentary Wi-Fi throughout resort

# Guest services

- Concierge team for all off site excursions
- Recreation team
- Wedding facilities
- The Gallery (boutique)
- Babysitting service
- Meeting facilities including Boardroom
- The Library (library, internet)

- Turtle Village (shopping and dining complex next to the villa resort)
- Anantara Spa (spa treatment, hairdressing and beauty salon.)
- Active zone (Muay Thai, 2 tennis courts, Teen zone, Kid playground, Kid rock climbing, Yoga & Matt pilates studio and Indoor & Outdoor Gym)



# Dining

## SEA FIRE SALT

Savour the artistry of grilled seafood and premium cuts, enhanced with Himalayan salt and kissed by the sea breeze — a dining experience that captures the essence of coastal elegance as the sun sets in golden splendour.

**Opening hours:** Dinner 6:00 pm – 10:00 pm

**Cuisine:** Seafood & Grill



## VAYU

Perched above Sea Fire Salt, the reimagined Vayu Rooftop is Mai Khao's premier sky sanctuary. Sweeping Andaman views, signature cocktails, rare vintages and reneé canapés create an elevated evening of taste, style and sophistication.

**Opening hours:** 5:00 pm - Midnight

**Cuisine:** Bar

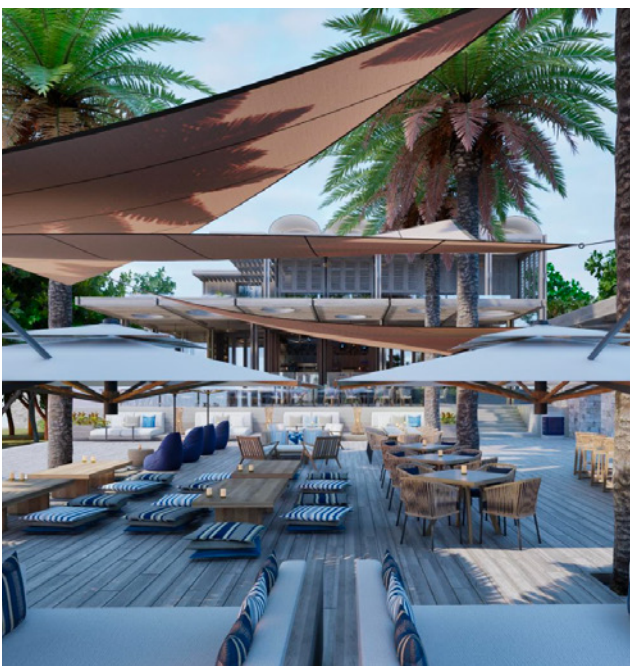

## INFINITY BAR

Enjoy refined cocktails, elegant bites, and relaxed sophistication in a chic setting overlooking the lagoon — the perfect spot for sundowners and unforgettable views as day turns to dusk.

**Opening hours:** 4:00 pm – 10:00 pm

**Cuisine:** Seafood & Grill



### LA SALA / TIFFIN BY LA SALA

Start your day with an extensive exotic buffet breakfast, thoughtfully curated to suit international tastes. For lunch and dinner, the lagoon-edged restaurant presents Tiffin by La Sala, offering spice-inspired Indian and Thai cuisine, along with an exquisite afternoon tea set, perfect for two. Savour the beauty of nature as you dine leisurely on the terrace.

**Opening hours:** Breakfast 7:00 am - 10:30 am  
Afternoon Tea 2:00 pm - 6:00 pm

**Cuisine:** Thai, Indian, Afternoon Tea set



### TREE HOUSE

Tree House is Phuket's most exclusive Omakase restaurant, named for the tree house in which it is perched overlooking tranquil lagoons. Each evening, the chef prepares an exquisite tasting menu, with ingredients that are flown in fresh from Japan. Explore our selection of rare sakes and imaginative Japanese-inspired cocktails.

**Opening hours:** 6:00 pm - Midnight

**Cuisine:** Japanese



### BUA BAR

Nestled along a serene lagoon, BUA Bar is one of the best bars in Phuket that offers an exceptional escape into sophistication. With over 100 premium white spirits, from gin to tequila, our extensive selection invites you to explore unique flavours. Savor expertly crafted cocktails prepared by our talented mixologists while enjoying the soft ambiance of modern jazz.

Step onto the waterside deck for a truly unforgettable experience, where every sip takes you on a journey of flavour and tranquillity.

**Operation hours:** 5:00 pm - Midnight

**Cuisine:** Bar



## TALAD

With its casual ambiance energised by lush foliage, Talad is a perfect alfresco spot to fuel up for the day ahead with nutrient-rich superfoods and classic breakfast favourites for sustained vitality. Enjoy a relaxing, casual lunch post-swim, or conclude your day with traditional Western delights, each spiced with our chef's signature touch.

**Opening hours:** Breakfast 7:00 am - 10:30 pm  
Lunch and dinner 12:00 pm - Midnight

**Cuisine:** Western & Thai



## CLAWS & CO

The best of Phuket's ocean delights. Phuket's one and only seafood shack offers an ideal setting for both afternoon and evening dining. Don an apron, roll up your sleeves and indulge in the freshest catch of the day, served generously by the bucket. Complement your meal with stylish cocktails and a glass (or two) of chilled wine.

**Opening hours:** 12:00 pm - Midnight

**Cuisine:** Freshest seafood



## DESIGNER DINING BY ANANTARA









Choose an intimate setting from dreamy locations throughout the resort and we will create a table just for two. Our chef will be craft a personalised menu, the Wine Guru can recommend fine wines and your private butler will tend to your every need. A magical experience not to be forgotten.



# Elevated gatherings in an island paradise

Host exceptional events at Anantara Mai Khao Phuket Villas, where bespoke service and breathtaking surroundings set the stage for unforgettable moments. From executive meetings to grand celebrations our elegant venues— ranging from sophisticated boardrooms to open-air beachfront settings—are designed for seamless, sophisticated experiences.

Enhance your event with curated island excursions, bespoke wellness programs and world-class dining, ensuring guests connect, unwind and leave with lasting impressions. With Anantara’s signature hospitality, every detail is meticulously crafted for flawless execution. Let us bring your vision to life in unparalleled luxury.

Meeting Rooms	Area		Dimension (L x W x H)									
					Theatre	Class-room	U-Shape	Board-room	Banquet of 10	Cocktail	H-Square	Cabaret
Andaman	m <sup>2</sup>	150.92	m	19.6 x 7.7 x 3	100	60	30	30	80	100	48	40
	ft <sup>2</sup>	1,624	ft	64.3 x 25.2 x 9.8								
Sarasin Boardroom	m <sup>2</sup>	19.98	m	5.4 x 3.7 x 3	-	-	-	12	-	-	12	-
	ft <sup>2</sup>	215	ft	17.7 x 12.1 x 9.8								
Andaman Beach Lawn	m <sup>2</sup>	1,250	m	25 x 50	-	-	-	-	200	400	-	-
	ft <sup>2</sup>	12,032.33	ft	73.35 x 164.04								

m<sup>2</sup> = square metres, ft<sup>2</sup> = square feet, m = metres, ft = feet

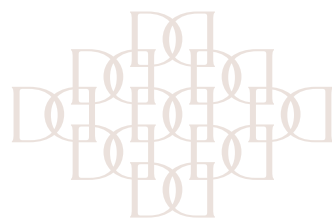

## Weddings and special occasions

Whether you are planning a fun-filled company trip, a boardroom meeting, a special celebration or a romantic wedding, the in-house events team will personalise your event for a truly unforgettable experience.

Anantara Mai Khao Phuket Villas offers state-of-the-art audiovisual technology, coffee breaks and dining experiences as well as an endless array of tailored excursions and activities. Productive meetings can be interspersed with rounds of golf on some of the world's best greens. Seamless conferences can be followed by Champagne cocktails on Major Affair, our 90' Sunseeker. Brainstorming and teambuilding with Spice Spoons, Anantara's signature cooking classes, visiting an ethical elephant sanctuary, island hopping and water sports will bring your visions to life.



# Anantara Spa

Experience tranquility amid silks and soothing fragrances at our Phuket spa resort. Imagine a tailor made journey that will help your mind, body and soul reach a blissful state of peace. The Spa at Anantara Mai Khao Phuket Villas, offers massages, elixirs, wraps and more in the open-air treatment rooms.

## SIGNATURE TREATMENT

### Anantara Signature Massage

Combining revered eastern and western techniques with Anantara's expertise, purpose designed movements and a signature oil blend stimulate the circulation and deeply relax muscles, while reflexology clears energy blockages to promote overall wellbeing.

## SPA FACILITIES

- Six luxurious treatment suites with private en-suite shower and bathroom facilities.
- Couple's treatments available for honeymooners, couple or friends.
- The Salon offers an extensive hair, makeup, waxing, pedicure and manicure for discerning gentlemen and ladies (advance reservation for hair or makeup service is required).
- Full range of professional skincare products, Comfort zone.



# Leisure and excursions

The setting of Anantara Mai Khao Phuket Villas is tranquil, but recreation and fun are always close by. Each day, the hotel has a whole host of activities on offer either in the resort or in the stunning surrounding area.

- Infinity swimming pool with swim-up bar
- Water sports including stand up paddle
- Board, body board and kayak
- Two tennis courts
- The Fitness Center
- Muay Thai, traditional Thai boxing
- The Gallery boutique
- Executive meeting and boardrooms
- The Library
- Spice Spoons cooking classes
- Cycling tours
- Yoga and other fitness classes



Embark on a journey of discovery through Thailand and indulge your senses with an assortment of activities.

## EXCURSIONS

- Private luxury boat excursion through the famed Phang Nga Bay on Major Affair, our 90' Sunseeker
- Late afternoon cruise on ajunk boat with on-board sunset cocktails
- Visit the ethical Phuket Elephant Sanctuary and whitewater rafting with private transfer
- Private fishing trip on a catamaran
- Scuba diving excursions
- Rounds of golf at the award-winning Blue Canyon golf and country club
- Sea kayak and limestone karst adventures
- Explore the Sino-Chinese Phuket Old Town walking market each Sunday evening
- Spice Spoons cooking classes
- Journey to the Enchanted Kingdom of Siam at Siam Niramit
- Spice Spoons cooking class with a visit to a local market with our Thai chef





## Airport transportation / access

Phuket has international and domestic terminals that are 15 minute's drive from the resort. The concierge team are pleased to arrange transfers to and from the airport, taxis are also available.

**Voltage:** 220 - 240 AC, 50 Hertz

**Currency:** Thai Baht (THB)  
USD 1 = THB 35 (subject to fluctuation)

**Time Zone:** GMT +7 hours

**Climate:** **November – February (Dry season)**  
Temperatures range from °C to °C accompanied by refreshing winds. Natural fibres and breathable clothing are recommended.

**March – May (Hot season)**  
Temperatures range from °C to °C. Natural fibres and breathable clothing are recommended.

**June – October (Monsoon season)**  
Temperatures range from °C to °C. Refreshing rain showers of ten last for only a short period before the skies become sunny once again. Natural fibres, breathable clothing and light waterproofs are recommended.

ANANTARA MAI KHAO PHUKET VILLAS

888 Moo 3, Mai Khao, Thalang, Phuket 83110 Thailand | +66 (0) 7633 6100 | [phuket@anantara.com](mailto:phuket@anantara.com)

[ANANTARA.COM](http://ANANTARA.COM)