



nhow
ROTTERDAM



URBA*





art, architecture and one hell of a view

Welcome to nhow Rotterdam. A design & lifestyle hotel where urban art and architecture become one. The hotel is located in the iconic building De Rotterdam, built by renowned architect Rem Koolhaas. It is located in an area known as 'Manhattan on the river Maas' and provides guests with unparalleled views and a sense of being at the heart of the city. The hotel embraces the unique identity and spirit of Rotterdam, by celebrating the city's art, architecture, and culture. nhow Rotterdam is more than just a place to stay, it has become a place to truly connect with the essence of the city.

You won't want to close the curtains with a view like this. Be free, get creative, meet, relax and stay at nhow. Choose between four different room categories and don't just visit Rotterdam – become part of it with its unique skyline view.



hotel & location

Rotterdam Central Station

3.6 km / 10 min drive | 4 stops metro D/E line

Rotterdam The Hague Airport

10 km / 16 min drive metro E line | Shuttle service available

The Hague Central Station

28 km / 30 min drive | 30 min metro E line

Ahoy Rotterdam

3.9 km / 10 min drive | 3 stops metro D/E line

Schiphol Amsterdam Airport

60 km / 50 min drive | 21 min fast train





274 inspiring rooms

Spread across 23 floors, the rooms offer comfort and panoramic views over the Rotterdam skyline, all to be enjoyed from the comfiest bed in town. You will be so close to the Erasmus bridge it will be impossible not to see it. After a restful night, the colours and shapes of the cityscape will awaken your senses and prepare you for a creative and energetic day ahead.

eat & drink

Start your day with a famous hnow breakfast. Enjoy a fluffy stack of pancakes, a freshly baked croissant and strong cup of coffee. Discover many flavours from around the world with our inspired street food menu.

Our cocktails are just as wild and colourful as the interior design from Elvy Gastrobar, so immerse yourself in the urban jungle or head out to our rooftop terrace to enjoy unparalleled views. Lean back and relax while sipping your cocktail and watching the sunset illuminate the skyline of Rotterdam.



gym & wellness

After an exciting day in Rotterdam, you're welcome to relax or exercise in our 70 m² gym. Break a sweat after a busy working day in our state-of-the-art fitness centre. If you'd rather take it easy, enjoy our spa area and the sauna with unbeatable views!



ROTTERDAM



host a meeting or event

nhow is the meeting place for forward thinkers. Host an event unlike anything you've ever organised before in the unique, creative and fully adaptive environment of nhow Rotterdam. The 11 meeting rooms have boundless flexibility and to the capacity to host events for up to 500 people. Bathed in all natural light thanks to Rem Koolhaas' open architecture, all our conference spaces have an awe-inspiring view, state-of-the-art technology, local urban art and top-notch catering. Simply put, our service is to do just about anything to make your event a success!





the loft

In addition to the amazing conference rooms, we are pretty sure that The Loft will add an extra 'wow' to your meetings & events.

The Loft is state-of-the-art Meetings & Events venue with 700m² of fully customisable space.

The best thing is you can host meetings and then throw an after-work party or drinks event, too.

- Unique open space
- Up to 400 guest capacity
- Floor-to-ceiling windows
- Custom-built mobile bar
- Movable separation walls
- Customisable lighting grid
- Top-notch F&B facilities
- Integrated audio / video facilities
- Unlimited customisability

capacity chart

room name	height (m)	area (m²)	 cocktail	 board- room	 carré	 class- room	 theatre	 u-shape	 cabaret	 dinner	daylight
nhow 1	3.4	46.8	38	18	24	18	38	18	29	18	✓
nhow 2	3.4	50.7	50	18	24	18	50	18	30	18	✓
nhow 3	3.4	126	150	36	45	42	150	39	70	36	✓
nhow 4	3.4	148	150	36	45	42	150	39	70	36	✓
nhow 5	3.4	148	110	36	45	42	110	39	70	36	✓
nhow 6	3.4	126	110	36	45	42	110	39	70	36	✓
nhow 7	3.4	67	60	18	24	24	60	18	39	18	✓
nhow 8	3.4	66		16-	-	-	-	-		16	✓
LOFT 1	3.4	61	40	12	22	24	40	18	30	12	✓
LOFT 2	3.4	285	250	32	42	60	120	38	90	150	✓
LOFT 3	3.4	258	150	30	46	60	100	36	70	100	✓
LOFT 2+3	3.4	543	400	96	46	120	220	38	160	250	✓
nhow 3+4			300	72	84	114	300	71	140	72	✓
nhow 2+3+4			350	72	84	132	350	71	170	72	✓
nhow 2+3			200	36	45	60	200	39	100	36	✓
nhow 5+6			240	72	54	84	240	48	150	72	✓
nhow 5+6+7			300	72	54	108	300	48	150	72	✓
nhow 6+7			170	36	45	66	170	39	100	36	✓

floor plan

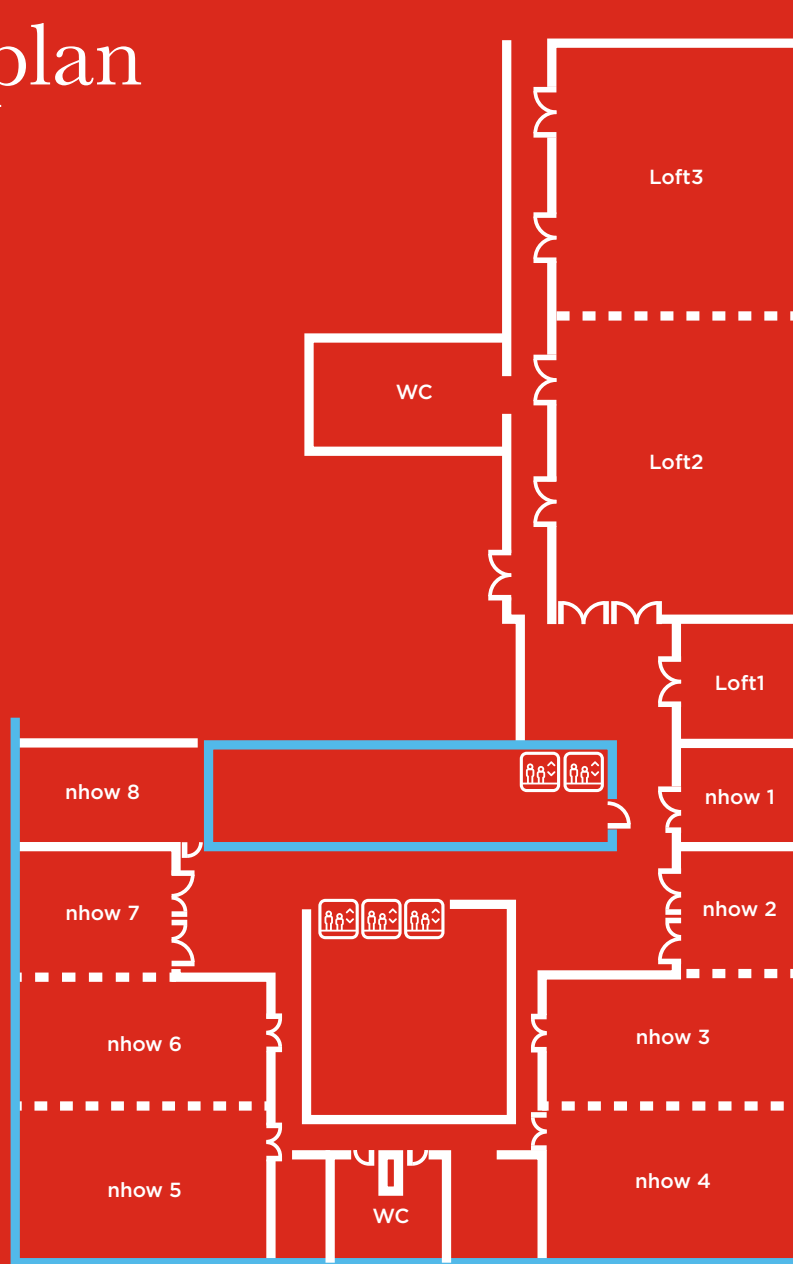

- glass
- removable dividers
- wall

our meeting packages

full day, 8 hrs



super power!



fully loaded



recharged



charging



getting started

Meeting room rental with free wi-fi	✓	✓	✓	✓	✓
Flip chart, screen & beamer	✓	✓	✓	✓	✓
Battery recharger lunch	✓	✓	✓	✓	✓
Tempting break: morning power	✓	✓	✓	✓	✓
Tempting break: afternoon power	✓	✓	✓	✓	✓
Always-on mineral water	✓	✓	✓	✓	
Welcome tea & coffee	✓	✓	✓	✓	
Always-on fruit in meeting room	✓	✓	✓	✓	
Always-on soft drinks for the sugar lovers	✓	✓	✓		
Always-on tea & coffee in our lounge	✓	✓	✓		
Water to go go go	✓	✓	✓		
Kickstart welcome package, upon arrival	✓	✓	✓		
Fresh juices and nhow style smoothies	✓	✓	✓		
Unplug closing package 1hr drinks & snacks	✓	✓			
Always-on power snacks in meeting room	✓	✓			
3 course energy dinner or buffet	✓				



You can also book our packages for **half a day** (4 hours) with or without lunch. Ask us for the options!

Packages available for groups from 10 people or more

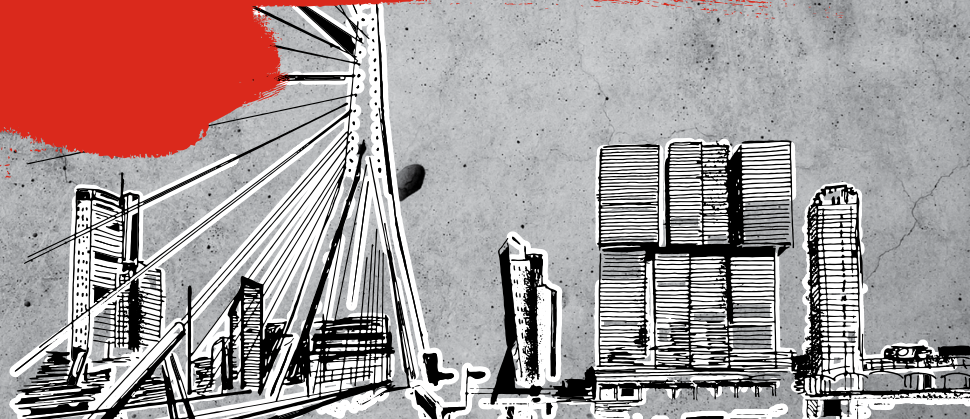



kickstart welcome package

Your first treat upon arrival! And first impressions count, so we've gone all out to impress with for example cookies, pastries, fresh fruit, natural yoghurt with a touch of fruit and crumbled apple pie. Tuck in!



power snacks in the meeting room

A power pack full of sweet and savoury snacks, from nut or muesli bars, to sweets, vegetable crisps and hand fruit.

morning power your tempting break in the morning

A healthy snack and a sweet guilty pleasure, served with refreshing drinks.



fresh juices and nhow style smoothies

Bright colours, tempting flavours, happy stomachs!



battery recharger lunch

A street food experience to share. Think fresh bread, delicious dips, cold cuts and surprising bites. Veggie options are always included to make sure there's something for everyone to enjoy.



afternoon power your tempting break in the afternoon

The perfect combo of something savoury and something sweet, plus colourful drinks to wash it all down.

unplug closing package

1hr drinks & snacks

Enjoy 3 snacks per person (meat, veggie, and fish options), and choose between soft drinks, draft beer, and house wine. Cheers to a hard day's work!



3-course energy dinner or buffet

A variety of tasty dishes to share, with flavors from around the world. Hot and cold starters, warm main course items including side dishes (veggie option is always included). And to finish: your very own dessert.



The images give an indication of the items that will be served, the actual dishes will change per season and hotel.

special event spaces

whether it's an exclusive dinner, a stylish cocktail reception or an unforgettable party – nhow Rotterdam offers unique spaces full of character in addition to your special events. Discover our versatile venues that combine atmosphere, design and functionality.

Elvy Gastrobar

Restaurant

Ideal for networking events, private parties, live shows

- Up to 130 seated / 400 standing
- Street food inspired menu & cocktails and shared dining
- Vegan, vegetarian, gluten-free options
- Rooftop terrace access
- Flexible layout: stage, dance floor, photobooth, LED light bar
- Independent sound system, DJ setup, microphones
- Private bar available

rooftop terrace

Ideal for summer events, casual receptions, creative workshops

- Outdoor terrace with skyline view
- Capacity: 40 seated / 60 standing
- Street food inspired menu & cocktails
- Vegan, vegetarian, gluten-free options
- Flexible layout: DJ booth, BBQ or paella setup
- Independent sound system, DJ setup, microphones

umbrella breakout area

Suitable for exhibitions, show cooking, networking.

- 50 people capacity – cocktail set up
- Event & break area
- Street food inspired snacks
- Located next to meeting rooms.





press contact

Sabrina Vader

s.vader@minor-hotels.com



nhow Rotterdam

Wilhelminakade 137, 3072 AP, Rotterdam, the Netherlands
+31 10 206 7600 | nhow-hotels.com



nhow Hotels & Resorts is a Minor Hotels brand.

nhow-hotels.com