

URBA

nhow  
ROTTERDAM

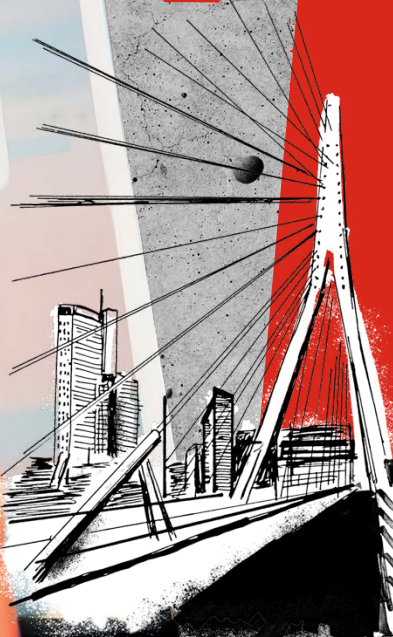

URBA\*



n





# art, architecture and one hell of a view

Welcome to nhow Rotterdam. A design & lifestyle hotel where urban art and architecture become one. The hotel is located in the iconic building De Rotterdam, built by renowned architect Rem Koolhaas. It is located in an area known as 'Manhattan on the river Maas' and provides guests with unparalleled views and a sense of being at the heart of the city. The hotel embraces the unique identity and spirit of Rotterdam, by celebrating the city's art, architecture, and culture. nhow Rotterdam is more than just a place to stay, it has become a place to truly connect with the essence of the city.

You won't want to close the curtains with a view like this. Be free, get creative, meet, relax and stay at nhow. Choose between four different room categories and don't just visit Rotterdam - become part of it with its unique skyline view.



## hotel & location

### **Rotterdam Central Station**

3.6 km / 10 min drive | 4 stops metro D/E line

### **Rotterdam The Hague Airport**

10 km / 16 min drive metro E line | Shuttle service available

### **The Hague Central Station**

28 km / 30 min drive | 30 min metro E line

### **Ahoy Rotterdam**

3.9 km / 10 min drive | 3 stops metro D/E line

### **Schiphol Amsterdam Airport**

60 km / 50 min drive | 21 min fast train





## 274 inspiring rooms

Spread across 23 floors, the rooms offer comfort and panoramic views over the Rotterdam skyline, all to be enjoyed from the comfiest bed in town. You will be so close to the Erasmus bridge it will be impossible not to see it. After a restful night, the colours and shapes of the cityscape will awaken your senses and prepare you for a creative and energetic day ahead.

# eat & drink

Start your day with a famous nhow breakfast. Enjoy a fluffy stack of pancakes, a freshly baked croissant and strong cup of coffee. Discover many flavours from around the world with our inspired street food menu.

Our cocktails are just as wild and colourful as the interior design from Elvy Gastrobar, so immerse yourself in the urban jungle or head out to our rooftop terrace to enjoy unparalleled views. Lean back and relax while sipping your cocktail and watching the sunset illuminate the skyline of Rotterdam.



# gym & wellness

After an exciting day in Rotterdam, you're welcome to relax or exercise in our 70 m<sup>2</sup> gym. Break a sweat after a busy working day in our state-of-the-art fitness centre. If you'd rather take it easy, enjoy our spa area and the sauna with unbeatable views!



**ROTTERDAM**



# host a meeting or event

nhow is the meeting place for forward thinkers. Host an event unlike anything you've ever organised before in the unique, creative and fully adaptive environment of nhow Rotterdam. The 11 meeting rooms have boundless flexibility and to the capacity to host events for up to 500 people. Bathed in all natural light thanks to Rem Koolhaas' open architecture, all our conference spaces have an awe-inspiring view, state-of-the-art technology, local urban art and top-notch catering. Simply put, our service is to do just about anything to make your event a success!



## the loft

In addition to the amazing conference rooms, we are pretty sure that The Loft will add an extra 'wow' to your meetings & events.







The Loft is state-of-the-art Meetings & Events venue with 700m<sup>2</sup> of fully customisable space.

The best thing is you can host meetings and then throw an after-work party or drinks event, too.

- Unique open space
- Up to 400 guest capacity
- Floor-to-ceiling windows
- Custom-built mobile bar
- Movable separation walls
- Customisable lighting grid
- Top-notch F&B facilities
- Integrated audio / video facilities
- Unlimited customisability



# capacity chart

room name	height (m)	area (m <sup>2</sup> )	 cocktail	 board- room	 carré	 class- room	 theatre	 u-shape	 cabaret	 dinner	daylight
nhow 1	3.4	46.8	38	18	24	18	38	18	29	18	✓
nhow 2	3.4	50.7	50	18	24	18	50	18	30	18	✓
nhow 3	3.4	126	150	36	45	42	150	39	70	36	✓
nhow 4	3.4	148	150	36	45	42	150	39	70	36	✓
nhow 5	3.4	148	110	36	45	42	110	39	70	36	✓
nhow 6	3.4	126	110	36	45	42	110	39	70	36	✓
nhow 7	3.4	67	60	18	24	24	60	18	39	18	✓
nhow 8	3.4	66		16-	-	-	-	-		16	✓
LOFT 1	3.4	61	40	12	22	24	40	18	30	12	✓
LOFT 2	3.4	285	250	32	42	60	120	38	90	150	✓
LOFT 3	3.4	258	150	30	46	60	100	36	70	100	✓
LOFT 2+3	3.4	543	400	96	46	120	220	38	160	250	✓
nhow 3+4			300	72	84	114	300	71	140	72	✓
nhow 2+3+4			350	72	84	132	350	71	170	72	✓
nhow 2+3			200	36	45	60	200	39	100	36	✓
nhow 5+6			240	72	54	84	240	48	150	72	✓
nhow 5+6+7			300	72	54	108	300	48	150	72	✓
nhow 6+7			170	36	45	66	170	39	100	36	✓

# floor plan

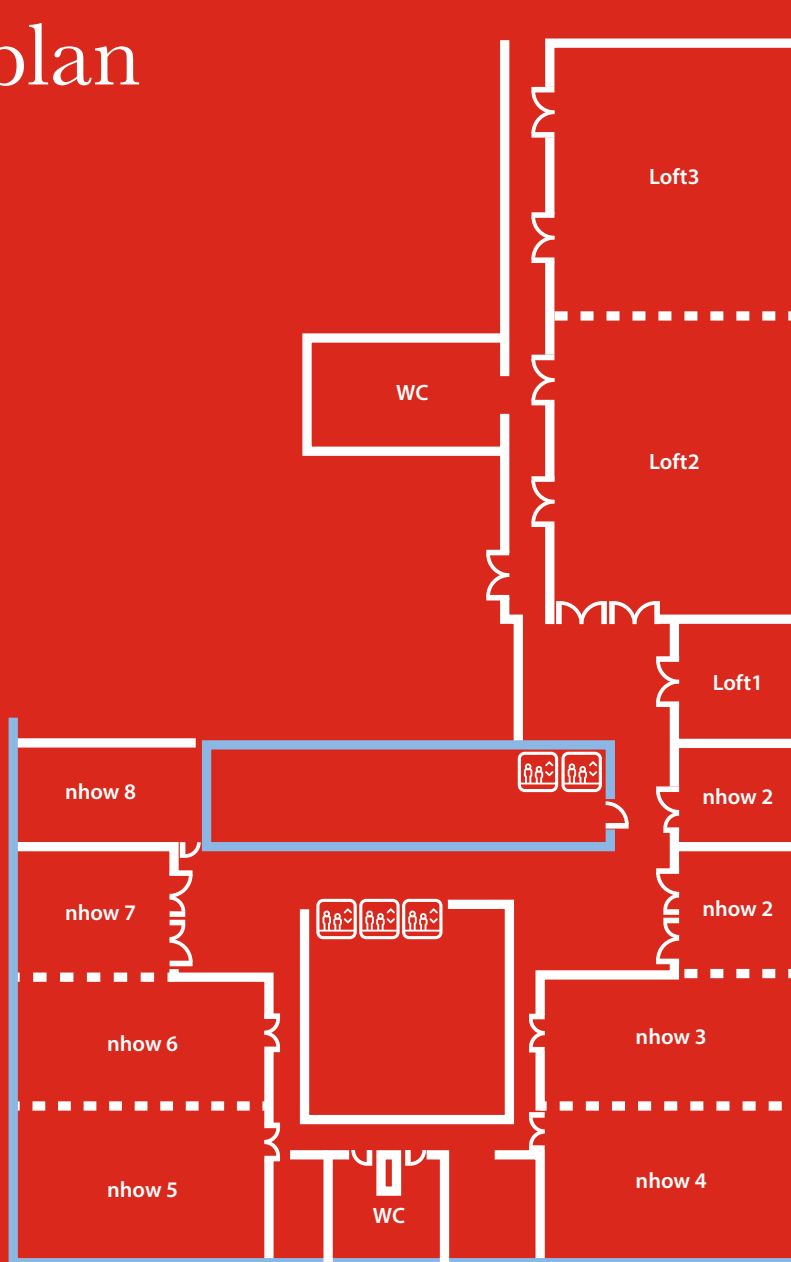

contact

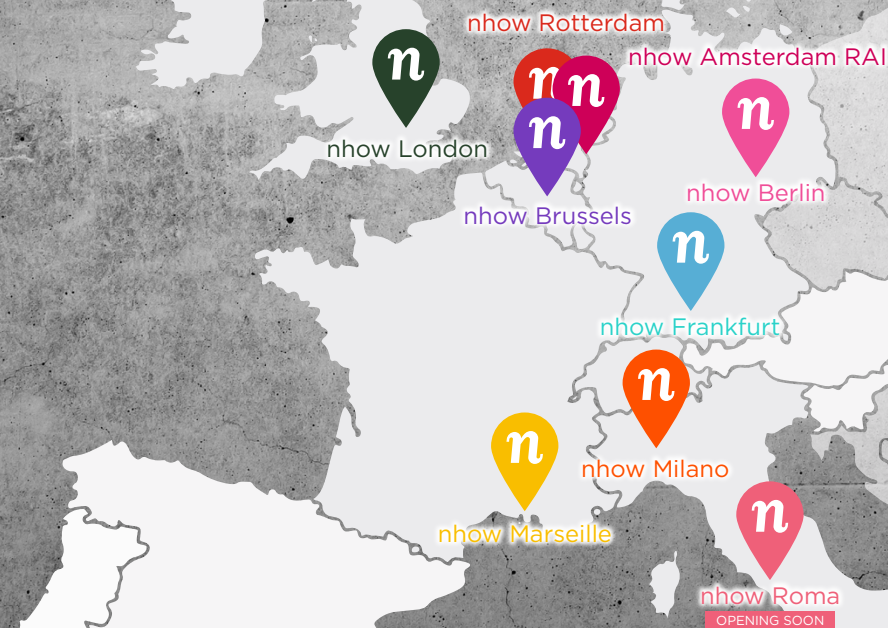

press contact

**Sabrina Vader**

communication.ne@nh-hotels.com

**nhow Rotterdam**

Wilhelminakade 137, 3072 AP, Rotterdam, the Netherlands  
+31 10 206 7600 | nhow-hotels.com